

265 Wandsworth

£1,550 Per Week



265 Wandsworth Bridge Road

£1,550 Per
Week

1 BED
Flat

0000
SQ FT

0000
SQ M

A smart and well-arranged one double bedroom apartment located amongst a residential area and moments away from the bars, shops and other local amenities of Wandsworth Bridge Road.

This third floor accommodation benefits from neutral decor throughout and comprises of one double bedroom, modern open-plan kitchen and excellent use of storage space.

This bright and airy property is only a short walk away from South Park as well as the transport links from Imperial Wharf (Overground) or Parsons Green (District Line) and would be perfect for a single professional or couple.

- One double bedroom
- Bathroom
- Open plan kitchen
- Fitted storage
- Close to local amenities
- Neutrally decorated
- Top floor
- Available: 29/04/2022
- Furnished



MATHEW GOSS
020 7384 6790
matthew@brik.co.uk





Location

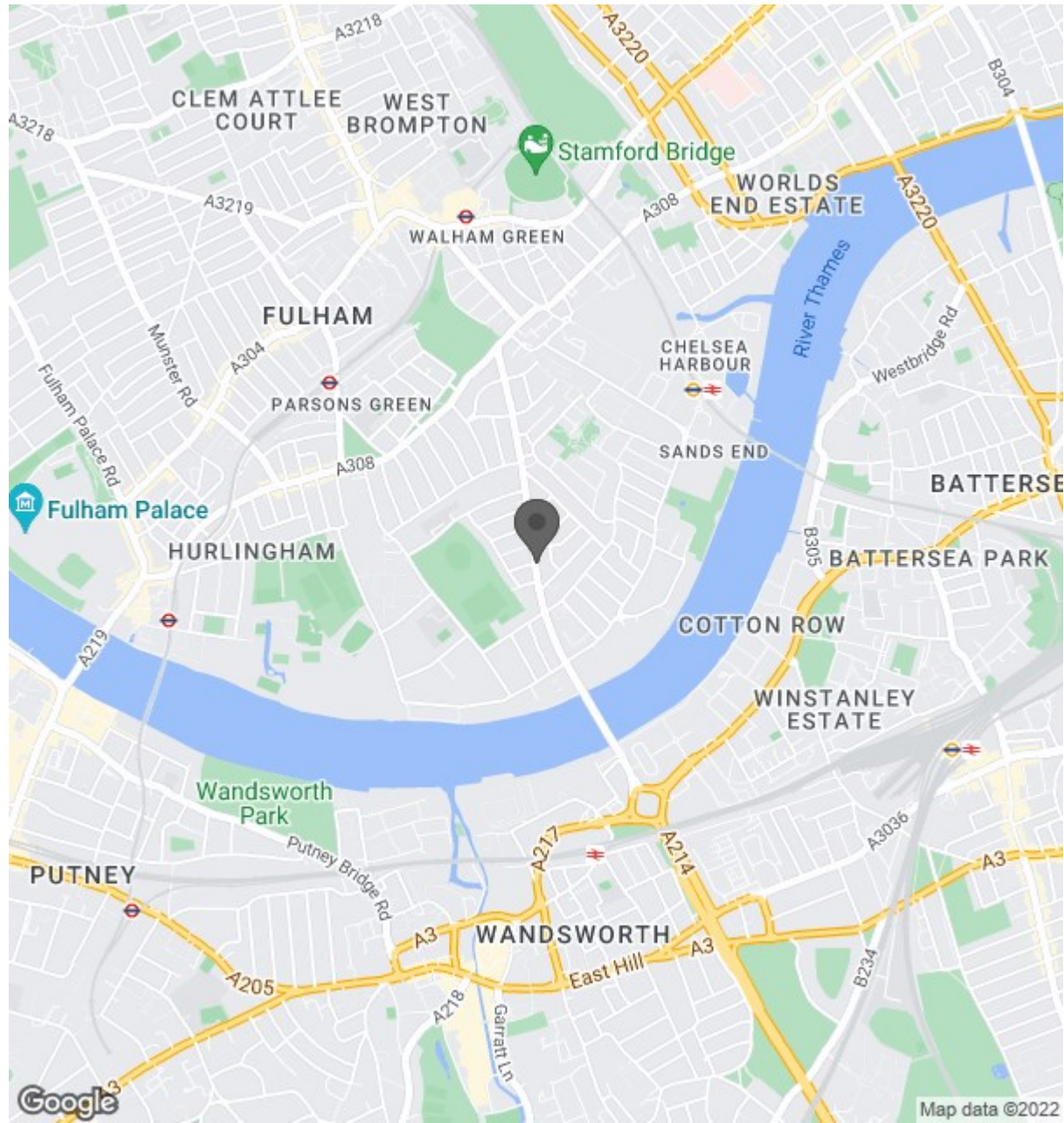

St. Matthews Court, SW6

Approximate gross internal area

31.77 sq m / 342 sq ft

Key :
CH - Ceiling Height

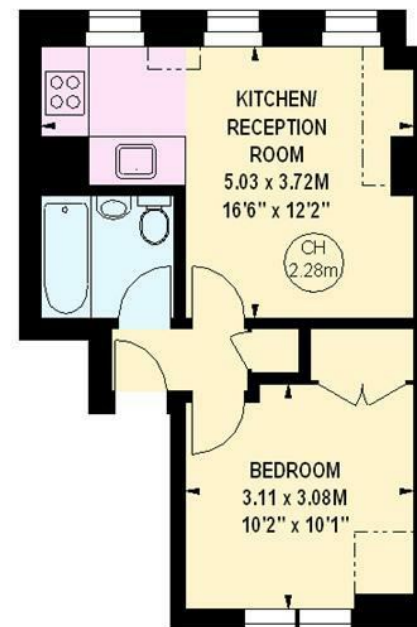
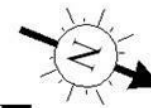

Third Floor

The floor plan is not to scale and measurements and areas shown are approximate and therefore should be used for illustrative purposes only. The plan has been prepared in accordance with the RICS code of Measuring Practice and whilst we have confidence in the information produced, it must not be relied on. If there is any aspect of particular importance, you should carry out or commission your own inspection of the property.
Copyright of FeaturePRO.